

Weld End Expansion Compensator Rated 2" Compression 1/2" Extension

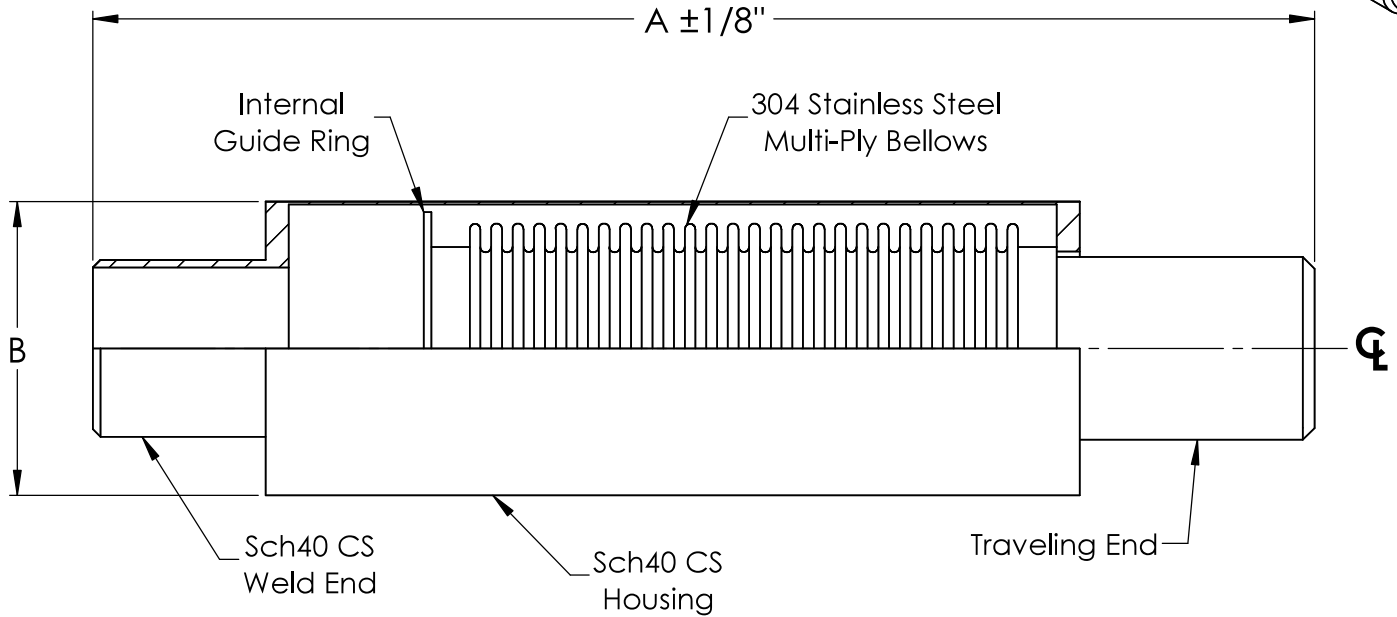
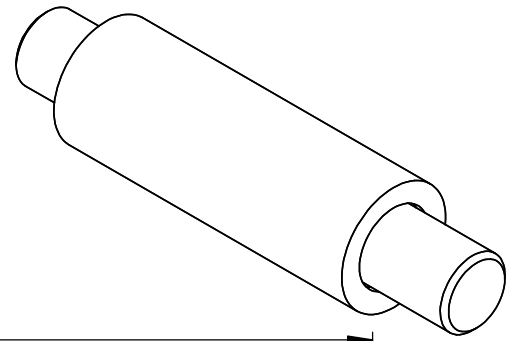

| QTY. | PART NUMBER | SIZE | | A (IN) | B (IN) | EFFECTIVE AREA (IN ²) | SPRING RATE (lbs/in) | WEIGHT | NOTES |
|------|-------------|--------|------|--------|--------|-----------------------------------|----------------------|--------|-------|
| | | (IN) | (MM) | | | | | | |
| | 120-075-3 | 3/4" | 20 | 12-3/4 | 3 | 1.5 | 81 | 3 | |
| | 120-10-3 | 1" | 25 | 13-1/4 | 3 | 2.1 | 88 | 4 | |
| | 120-12-3 | 1-1/4" | 32 | 13-1/4 | 3 | 3.3 | 75 | 5 | |
| | 120-15-3 | 1-1/2" | 38 | 14-5/8 | 3-1/2 | 4.3 | 121 | 7 | |
| | 120-20-3 | 2" | 50 | 14-5/8 | 4 | 6.3 | 143 | 10 | |
| | 120-25-3 | 2-1/2" | 65 | 16 | 5 | 8.8 | 187 | 14 | |
| | 120-30-3 | 3" | 80 | 16 | 5-1/2 | 13.1 | 230 | 18 | |
| | 120-40-3 | 4" | 100 | 16-3/8 | 6-5/8 | 20.8 | 484 | 25 | |

THIS EXPANSION JOINT IS DESIGNED FOR AXIAL MOVEMENT ONLY. PIPING MUST BE PROPERLY GUIDED AND ANCHORED PER THE RECOMMENDATIONS OF THE EXPANSION JOINT MANUFACTURERS ASSOCIATION.

NOTES:

NSF 372 - LEAD FREE: The wetted surface of this product contacted by water contains less than one quarter of one percent (0.25%) of lead by weight. Material complies with state codes and standards where applicable, requiring reduced lead content.

| | |
|-------------------|--------------------|
| Temperature | 750°F (399°C) |
| Pressure | 175 PSI (1206 kPa) |
| Test Pressure | 250 PSI (1809 kPa) |
| Axial Compression | 2" (50mm) |
| Axial Extension | 1/2" (13mm) |

REV. DRAWN BY: Date: 7/31/2020



Customer:

Project:

Style: HHWE Series - Weld End Compensator

SCALE: NONE DRAWING NUMBER: